

# Pecurka Dani Piva ZR 2010

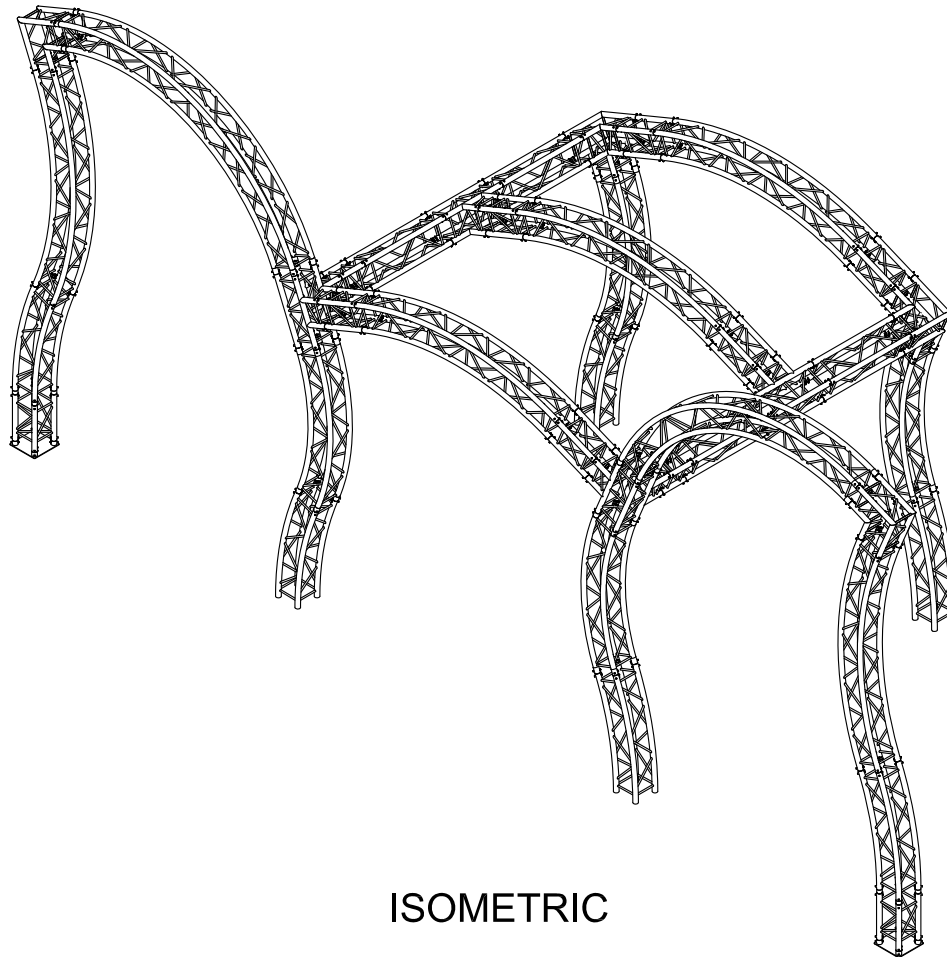

ISOMETRIC

<b>CHAMELEON</b> d.o.o.		Datum: 23.08.2010.
Naziv Projekta: Montažno-Demontažna Alu. Konstrukcija Pecurka Dani Piva ZR 2010		Crtež br. 10/08/23 - 1
Pogled: Kosa Projekcija Mere u mm	Projekat Radio: Milan Đurasinović gandi@chameleon.rs	Odobrio: Ivan Kršev ivan@chameleon.rs
Napomena: Svi elementi podležu TUV standardu, kao i DIN 4113-1 i DIN 4113-2		
21000 Novi Sad, Stevana Mokranjca 4, Tel: + 381 (0) 21/6 32 11 16 www.chameleon.rs office@chameleon.rs		

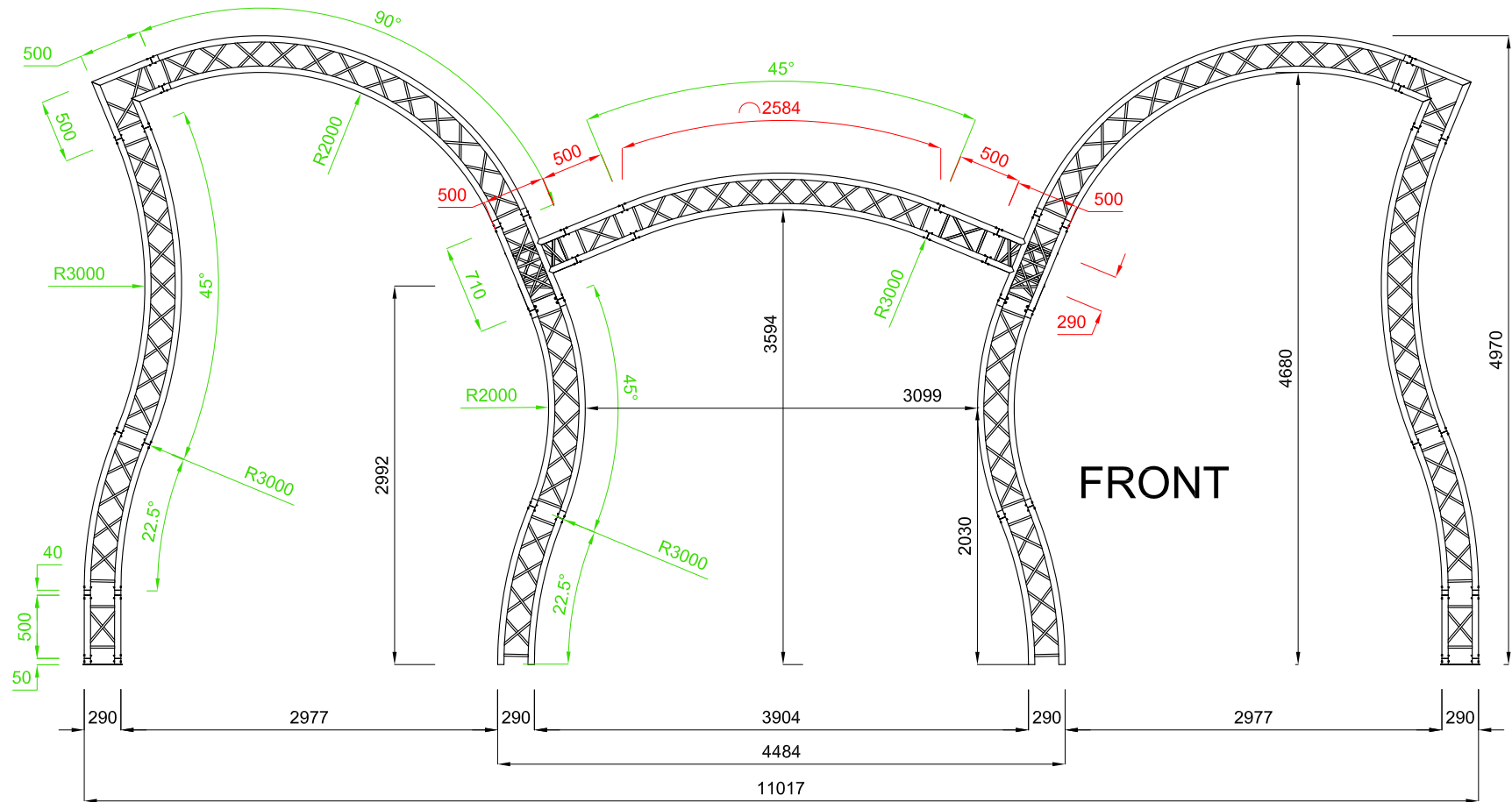

**CHAMELEON** d.o.o.

Datum: 23.08.2010.

Naziv Projekta: Montažno-Demontažna Alu. Konstrukcija  
Pecurka Dani Piva ZR 2010

Crtež br. 10/08/23 - 2

Pogled: Front  
Mere u mm

Projekat Radio: Milan Đurasinović  
gandi@chameleon.rs

Odobrio: Ivan Kršev  
ivan@chameleon.rs

Napomena: Svi elementi podležu TUV standardu, kao i DIN 4113-1 i DIN 4113-2

21000 Novi Sad, Stevana Mokranjca 4, Tel: + 381 (0) 21/6 32 11 16 www.chameleon.rs office@chameleon.rs

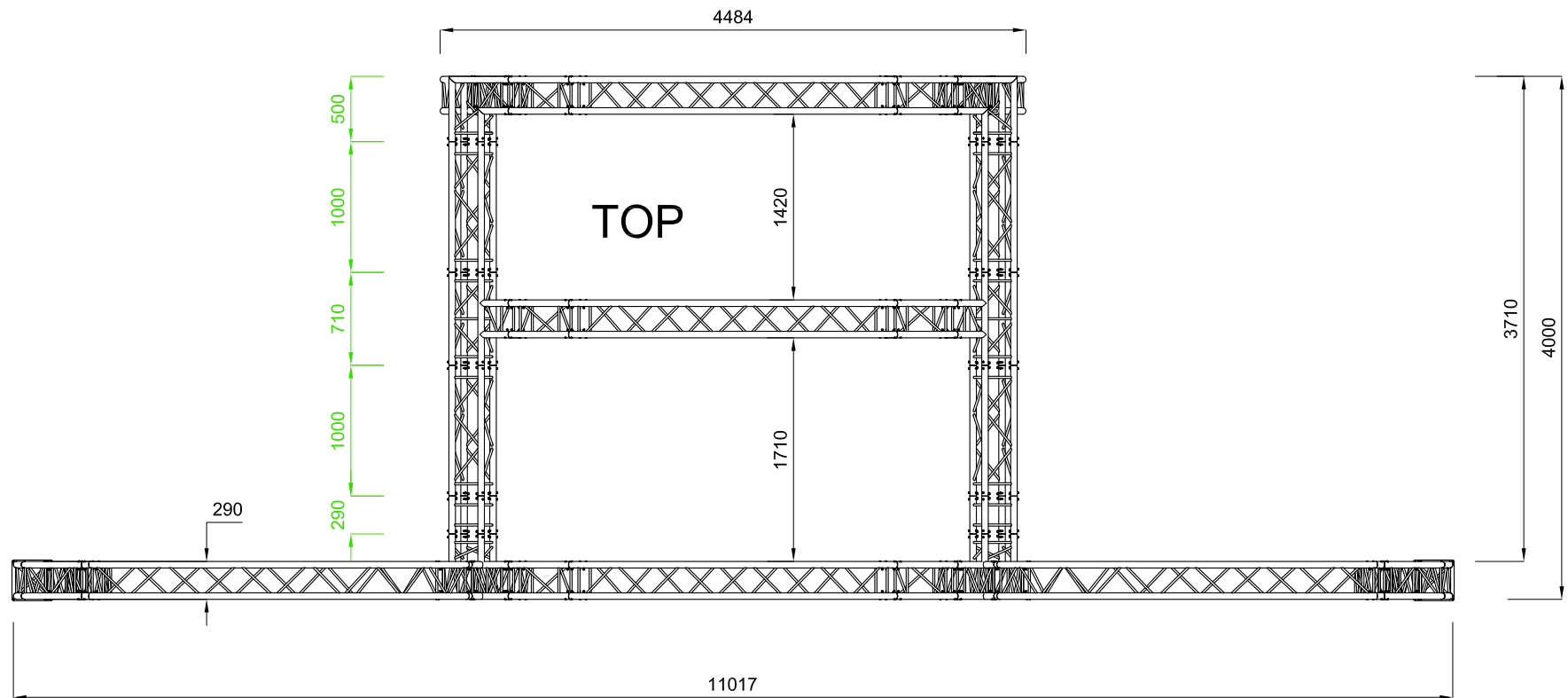

<b>CHAMELEON</b> d.o.o.		Datum: 23.08.2010.
Naziv Projekta: Montažno-Demontažna Alu. Konstrukcija Pecurka Dani Piva ZR 2010		Crtež br. 10/08/23 - 3
Pogled: Odozgo Mere u mm	Projekat Radio: Milan Đurasinović gandi@chameleon.rs	Odobrio: Ivan Kršev ivan@chameleon.rs
Napomena: Svi elementi podležu TUV standardu, kao i DIN 4113-1 i DIN 4113-2		
21000 Novi Sad, Stevana Mokranjca 4, Tel: + 381 (0) 21/6 32 11 16 www.chameleon.rs office@chameleon.rs		

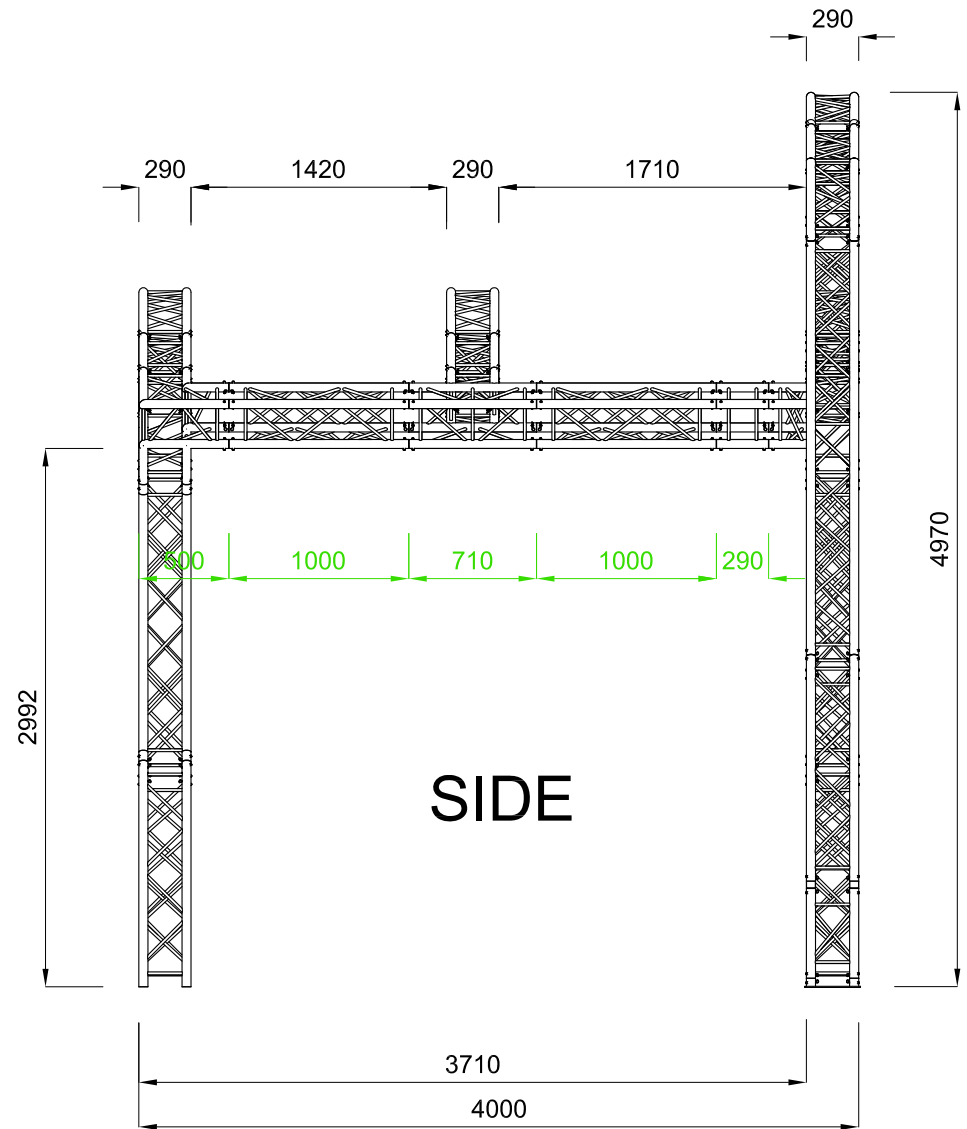

<b>CHAMELEON</b> d.o.o.		Datum: 23.08.2010.
Naziv Projekta: Montažno-Demontažna Alu. Konstrukcija Pecurka Dani Piva ZR 2010		Crtež br. 10/08/23 - 4
Pogled: Sa Strane Mere u mm	Projekat Radio: Milan Đurasinović gandi@chameleon.rs	Odobrio: Ivan Kršev ivan@chameleon.rs
Napomena: Svi elementi podležu TUV standardu, kao i DIN 4113-1 i DIN 4113-2		
21000 Novi Sad, Stevana Mokranjca 4, Tel: + 381 (0) 21/6 32 11 16 www.chameleon.rs office@chameleon.rs		



## Pecurka Dani Piva ZR 2010.xlsx

Naziv	kom.	kg	m (30)	m (40)	m <sup>2</sup>	Objašnjenje	Proizvođač
TQ4-29-0290	2	5.0	0.6				TAF
TQ4-29-0500	8	27.6	4.0				TAF
TQ4-29-1000	4	22.4	4.0				TAF
TQ4-29-21 L	2	9.0	2.0			30 - L	TAF
TQ4-29-30 C	2	11.8	3.0			30 - C	TAF
TQ4-29-35 T	2	11.8	2.4			30 - T	TAF
TQ4-29-42 K	2	14.8	3.4			30 - K	TAF
TQ4-29-BP	2	4.2	0.1			Base Plate	TAF
TQ4-29-C-4000-45°	4	32.0	7.2			Krug 4m - 45°	TAF
TQ4-29-C-4000-90°	2	30.8	7.2			Krug 4m - 90°	TAF
TQ4-29-C-6000-22.5°	6	39.6	7.7			Krug 6m - 22.5°	TAF
TQ4-29-C-6000-45°	5	58.5	12.9			Krug 6m - 45°	TAF
TQ-CON	160	24.0				Konus	TAF
TQ-OCON-40	8	2.8				Distancer 40 mm	TAF
TQ-P	336	15.1				Klin	TAF
TQ-SP	336	1.0				Snala	TAF

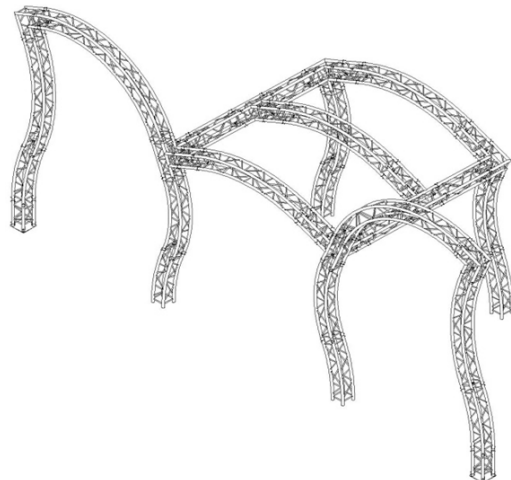

## UKUPNO

Truss 30	54.6	m
----------	------	---

Težina	310.4	kg
--------	-------	----